

MAYWOOD  STUDIO

# Candy Dish Tree Skirt

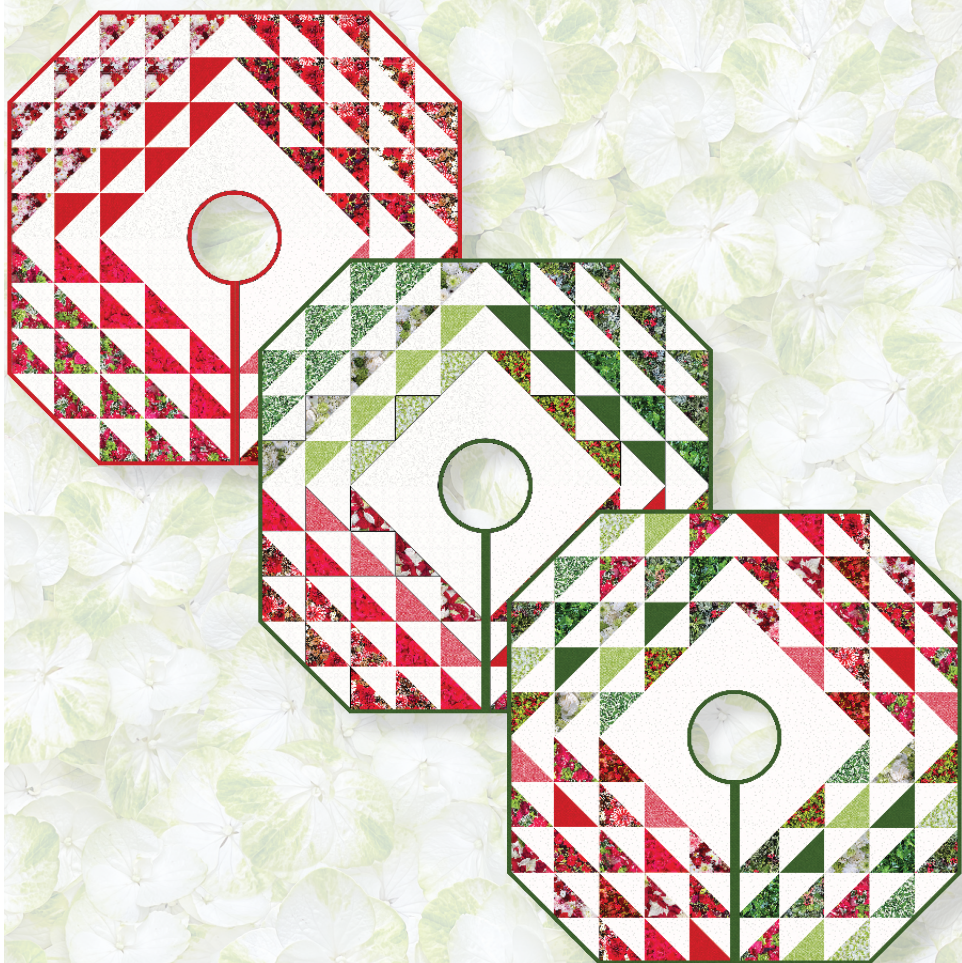

## Candy Dish Tree Skirt - Three Ways! 40" x 40"

Featuring Handpicked: Christmas by Nicholas Lapp  
Make this project with 5" squares, 10" squares, or Fat Quarters

[maywoodstudio.com](http://maywoodstudio.com)

HAND PICKED  
CHRISTMAS  
BY NICHOLAS LAPPE

HAND PICKED: CHRISTMAS FABRICS



SOLITAIRE WHITE BACKGROUND FABRICS

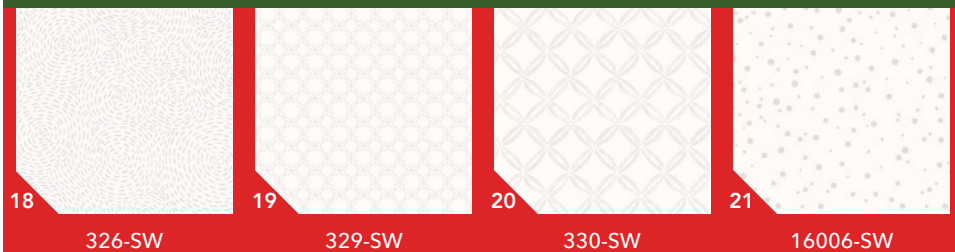

**CANDY DISH TREE SKIRT - 3 WAYS**

Please read all instructions before you begin. Seam allowance is 1/4". Fabric is abbreviated as F and by number. For example, Fabric 1 is 'F1'. Press seams in the direction of the arrows.

There are three different sets of instructions: Fat Quarters, 10" Squares, and 5" squares. Make sure to follow the instructions for the precut version of your choice.

The Fat Quarter and 10" square versions use 4 different white background fabrics. You can switch to use a single one for these options. Follow the yardage and cutting for the 5" square version for a single background fabric.

Make it your own! Follow our illustrations or arrange the fabrics to your liking.

### 10" SQUARE FABRIC REQUIREMENTS

PRECUT	SQ-MASSPCH	1 PACK
FABRIC 18	MAS326-SW	1/3 YARD
FABRIC 19	MAS329-SW	1/3 YARD
FABRIC 20	MAS330-SW	1/3 YARD
FABRIC 21	MAS16006-SW	1/3 YARD
BINDING	10723-GG	1/2 YARD
BACKING	YOUR CHOICE	1-1/4 YARDS

### 10" SQUARE CUTTING

10" Square Fabrics: 1/4/14/16  
Cut (4) 5" squares from each.

10" Square Fabrics: 3/5/9/13  
Cut (3) 5" squares from one of each.

10" Square Fabrics: 2/6/7/8/10/12/15/17  
Cut (2) 5" squares from each.

White Fabrics: 18/19/20/21  
Cut (2) 5" x WOF strips from each into:  
(12) 5" squares. Cut 1 square on the diagonal.  
(3) 4-1/2" squares

Fabric 2 Binding: Cut (6) 2-1/4" x WOF strips

### 5" SQUARE FABRIC REQUIREMENTS

PRECUT	CP-MASSPCH	1 PACK
FABRIC 21	MAS16006-SW	1 YARD
BINDING	10723-GG	1/2 YARD
BACKING	YOUR CHOICE	1-1/4 YARDS

### 5" SQUARE CUTTING

The Hand Picked: Christmas Charm Pack includes

2 of each of these fabrics: 2/3/6-12/14-17

3 of each of these fabrics: 1/4/5/13

White Fabric 21  
Cut (7) 5" x WOF strips into:  
(42) 5" squares. Cut 4 squares on the diagonal.  
(12) 4-1/2" squares

Fabric 2 Binding: Cut (6) 2-1/4" x WOF strips

### FAT QUARTER FABRIC REQUIREMENTS

FABRIC 9	10721-RG	1 FAT QUARTER
FABRIC 10	10720-RG	1 FAT QUARTER
FABRIC 11	10719-R	1 FAT QUARTER
FABRIC 12	10723-R	1 FAT QUARTER
FABRIC 13	10718-R	1 FAT QUARTER
FABRIC 14	10715-RW	1 FAT QUARTER
FABRIC 15	10723-RW	1 FAT QUARTER
FABRIC 16	10716-RW	1 FAT QUARTER
FABRIC 18	MAS326-SW	1/3 YARD
FABRIC 19	MAS329-SW	1/3 YARD
FABRIC 20	MAS330-SW	1/3 YARD
FABRIC 21	MAS16006-SW	1/3 YARD
BINDING	10723-R	1/2 YARD
BACKING	YOUR CHOICE	1-1/4 YARDS

### FAT QUARTER CUTTING

Fat Quarter Fabrics: 9/11/14/16  
Cut (6) 5" squares from each.

Fat Quarter Fabrics: 10/12/13/15  
Cut (4) 5" squares from each.

White Fabrics: 18/19/20/21  
Cut (2) 5" x WOF strips from each into:  
(11) 5" squares. Cut 1 square on the diagonal.  
(3) 4-1/2" squares

Fabric 12/Binding: Cut (6) 2-1/4" x WOF strips

WOF - Width of Fabric  
LOF - Length of Fabric  
RST - Right Sides Together  
HST - Half Square Triangle

Candy Dish Tree Skirt 10" Square Version

Half Square Triangles (HSTs)

Gather (11) F18 5" squares, (4) F4 5" squares, (3) F5 5" squares, (2) F6 4-½" squares, and (2) F7 5" squares.

- 1. Draw a diagonal line from corner to corner on the wrong side of all (11) F18 squares.
- 2. Place an F18 square, RST over an F4 square. Sew ¼" away from either side of the marked line. Cut on the marked line. Press away from F18. Make 4 pairs for 7 HST: there will be 1 left over. Trim to 4-½.
- 3. Repeat steps 1-2 to make the following HST pairs. There will be leftover HSTs if there is an odd number needed.

F18: (5) F5, (4) F7, (3) F6, and \*(7) F4 were made above.  
F19: (7) F14, (5) F13, (4) F15 and (3) F17  
F20: (7) F1, (5) F3, (4) F2 and (3) F8  
F21: (7) F16, (5) F9, (4) F12 and (3) F10

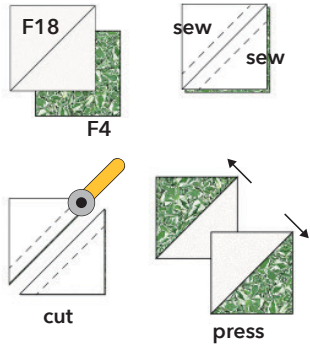

**Top Left Quadrant:** use the F18 HST pairs  
Gather the (7) F18/F4 HSTs, (5) F18/F5 HSTs, (4) F18/F7 HSTs, (3) F18/F6 HSTs, (3) F18 4-½" squares, and (2) F18 triangles.

- 1. Arrange as shown below.
- 2. Sew into rows. Press in alternate directions, starting to the right.
- 3. Sew rows together. Press downwards.

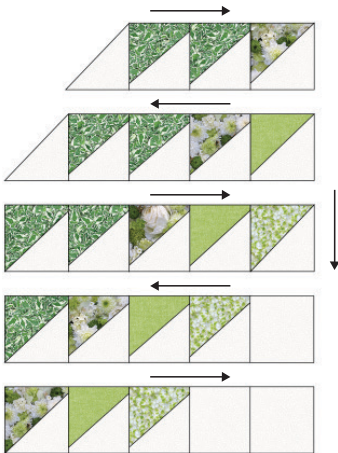

**Top Right Quadrant:** use the F20 HST pairs  
Gather the (7) F20/F1 HSTs, (5) F20/F3 HSTs, (4) F20/F2 HSTs, (3) F20/F8 HSTs, (3) F20 4-½" squares, and (2) F20 triangles.

- 1. Arrange as shown below.
- 2. Sew into rows. Press in alternate directions, starting to the right.
- 3. Sew rows together. Press upwards.

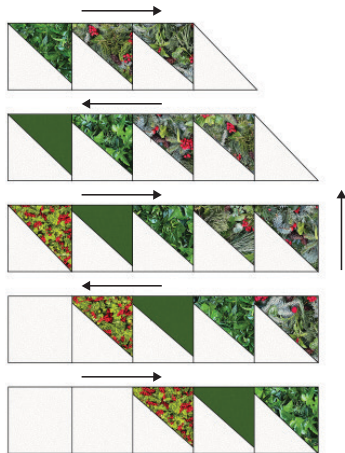



1. Arrange as shown below.

2. Sew into rows. Press in alternate directions, starting to the left.
3. Sew rows together. Press downwards.

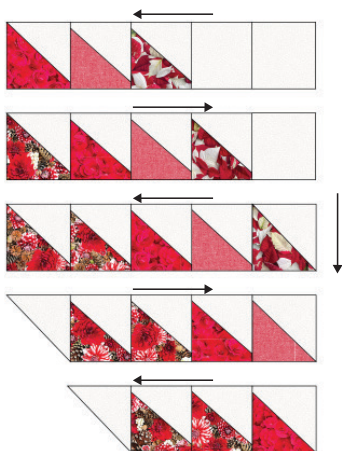

1. Arrange as shown below.

2. Sew into rows. Press in alternate directions, starting to the left.
3. Sew rows together. Press upwards.

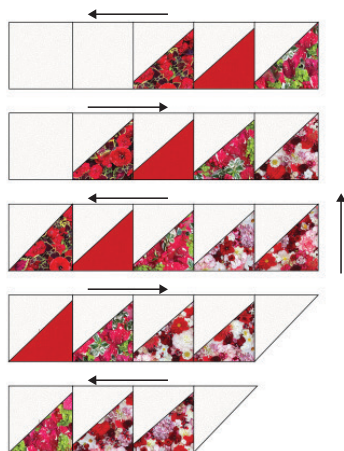

1. Sew the two left quadrants together and press downwards.

2. Sew the two right quadrants together. Press upwards.
3. Sew the left and right halves together, nesting seams. Press open.

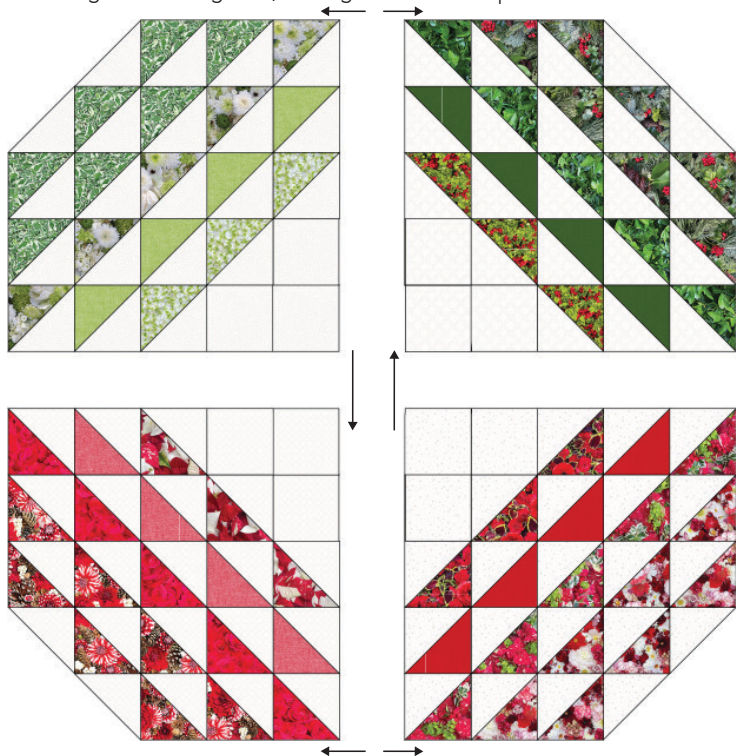

## Candy Dish Tree Skirt 5" Square Version

### Half Square Triangles

Gather (38) F21 5" squares and the colorful 5" squares from the charm pack.

1. Draw a diagonal line from corner to corner on the wrong side of all (38) F21 squares.
2. Place an F21 square, RST over a colorful square. Sew  $\frac{1}{4}$ " away from either side of the marked line. Cut on the marked line. Press away from F21. Trim to  $4\frac{1}{2}$ ".
3. Repeat for the remaining F21 squares and colorful squares.

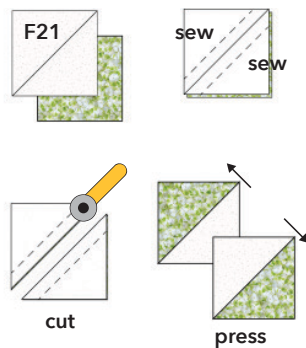

### Top Left/Bottom Right Quadrants:

Gather the green HSTs (F1-F8), (6) F21  $4\frac{1}{2}$ " squares, and (4) F21 triangles.

1. Arrange half of the HSTs, (3) F21  $4\frac{1}{2}$ " squares, and (2) F21 triangles as shown to the right.
2. Sew into rows. Press in alternate directions, starting to the right.
3. Sew rows together. Press downwards.
4. Repeat steps 1-3 with the remaining green HSTs,  $4\frac{1}{2}$ " squares, and triangles.

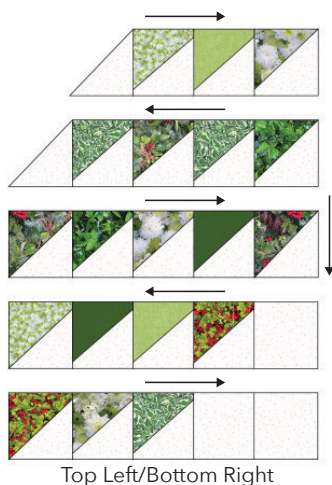

### Bottom Left/Top Right Quadrants:

Gather the red HSTs (F9-F17), (6) F21  $4\frac{1}{2}$ " squares, and (4) F21 triangles.

1. Arrange half of the HSTs, (3) F21  $4\frac{1}{2}$ " squares, and (2) F21 triangles as shown to the right.
2. Sew into rows. Press in alternate directions, starting to the left.
3. Sew rows together. Press upwards.
4. Repeat steps 1-3 with the remaining red HSTs,  $4\frac{1}{2}$ " squares, and triangles.

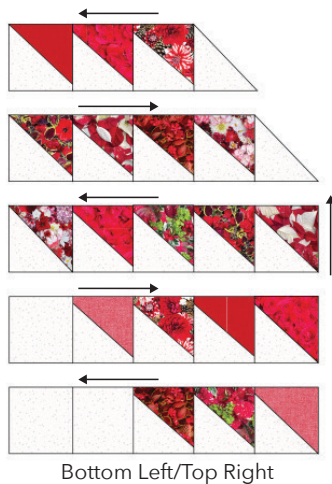

**Skirt Top Assembly**

- 1. Lay out the 4 quadrants, as shown, paying attention to the orientation.
- 2. Sew the two left quadrants together and press downwards.
- 3. Sew the two right quadrants together. Press upwards.
- 4. Sew the left and right halves together, nesting seams. Press open.

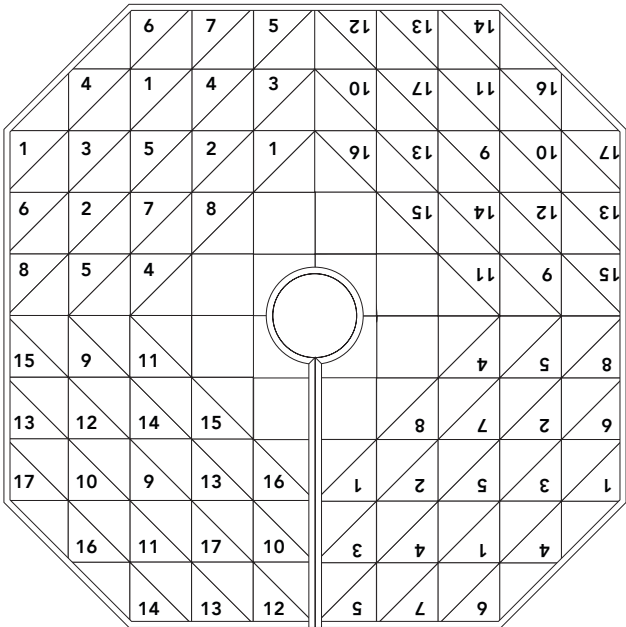
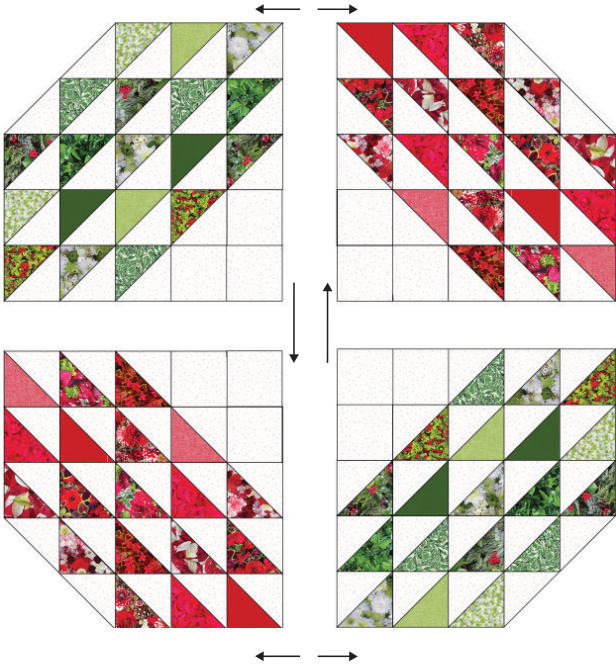

Candy Dish Tree Skirt Fat Quarter Version

Half Square Triangles (HSTs)

Gather (10) F18 5" squares, (6) F16 5" squares, and (4) F12 5" squares.

1. Draw a diagonal line from corner to corner on the wrong side of all (10) F18 squares.
2. Place an F18 square, RST over an F16 square. Sew ¼" away from either side of the marked line. Cut on the marked line. Press away from F18. Make 6 pairs for 12 HSTs. Trim to 4-½".
3. Place an F18 square, RST over an F12 square. Sew ¼" away from either side of the marked line. Cut on the marked line. Press away from F18. Make 4 pairs for 7 HSTs. Trim to 4-½". There will be one leftover HST.
4. Repeat steps 1-3 to make the following HST pairs:
  - a. (12) F20/F14 and (7) F20/F10
  - b. (12) F19/F9 and (7) F19/F13
  - c. (12) F21/F11 and (7) F21/F15

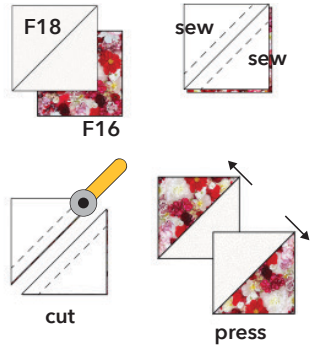

Top Left Quadrant:

Gather (12) F18/F16 HSTs, (7) F18/F12 HSTs, (3) F18 4-½" squares, and (2) F18 triangles.

1. Arrange as shown below.
2. Sew into rows. Press in alternate directions, starting to the right.
3. Sew rows together. Press downwards.

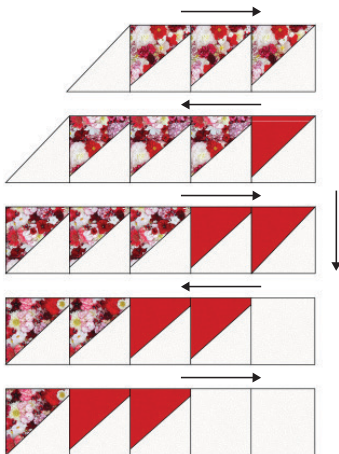

Top Right Quadrant:

Gather (12) F20/F14 HSTs, (7) F20/F10 HSTs, (3) F20 4-½" squares, and (2) F20 triangles.

1. Arrange as shown below.
2. Sew into rows. Press in alternate directions, starting to the right.
3. Sew rows together. Press upwards.

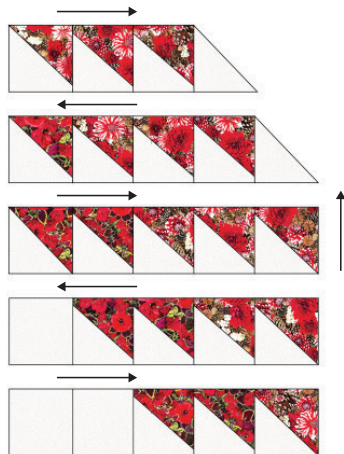



**Bottom Left:**

Gather (12) F19/F9 HSTs, (7) F19/F13 HSTs, (3) F19 4-½" squares, and (2) F19 triangles.

1. Arrange as shown below.
2. Sew into rows. Press in alternate directions, starting to the left.
3. Sew rows together. Press downwards.

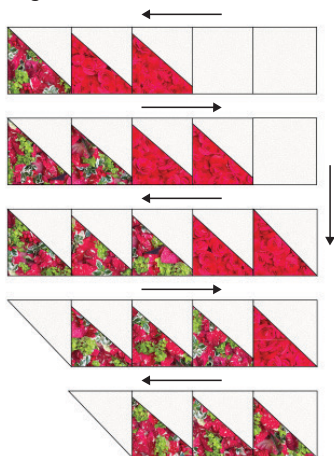
**Bottom Right:**

Gather (12) F21/F11 HSTs, (7) F21/F15 HSTs, (3) F21 4-½" squares, and (2) F21 triangles.

1. Arrange as shown below.
2. Sew into rows. Press in alternate directions, starting to the left.
3. Sew rows together. Press upwards.

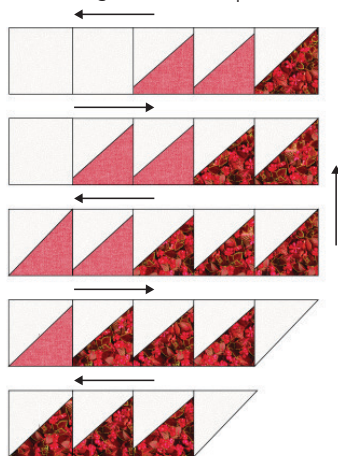
**Skirt Top Assembly**

1. Sew the two left quadrants together and press downwards.
2. Sew the two right quadrants together and press upwards.
3. Sew the left and right halves together, nesting seams. Press open.

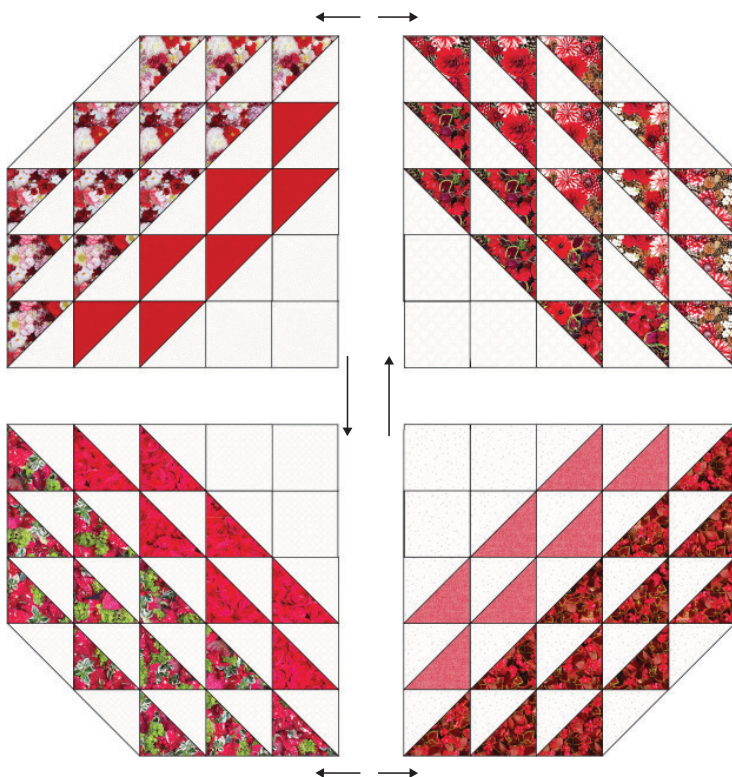

## Tree Skirt Finishing

1. Layer the backing (wrong side up), batting and tree skirt top (right side up). Baste layers to secure. Quilt as desired. Trim the excess backing and batting.
2. Use the 6" circle template on the facing page for marking the cut-out center of the tree skirt. If you prefer a larger circle trace the size you desire onto heavy paper or the like and cut it out.
3. Lay your quilted tree skirt top out on a flat surface. Find the center and use the circle template to trace your circle onto the tree skirt
4. Cut a straight line from the edge of the skirt up to the circle and cut out the circle.
5. Sew the binding strips together into one continuous strip. Press in half length-wise. Sew the binding to the quilt top with a 1/4" seam allowance. Turn the binding to the back side of the quilt and stitch down by hand with matching thread.

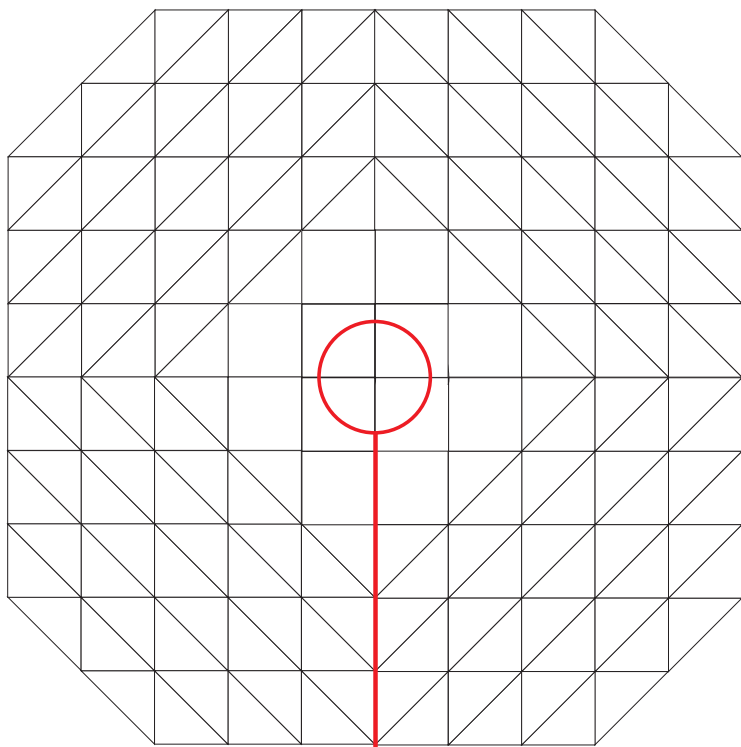

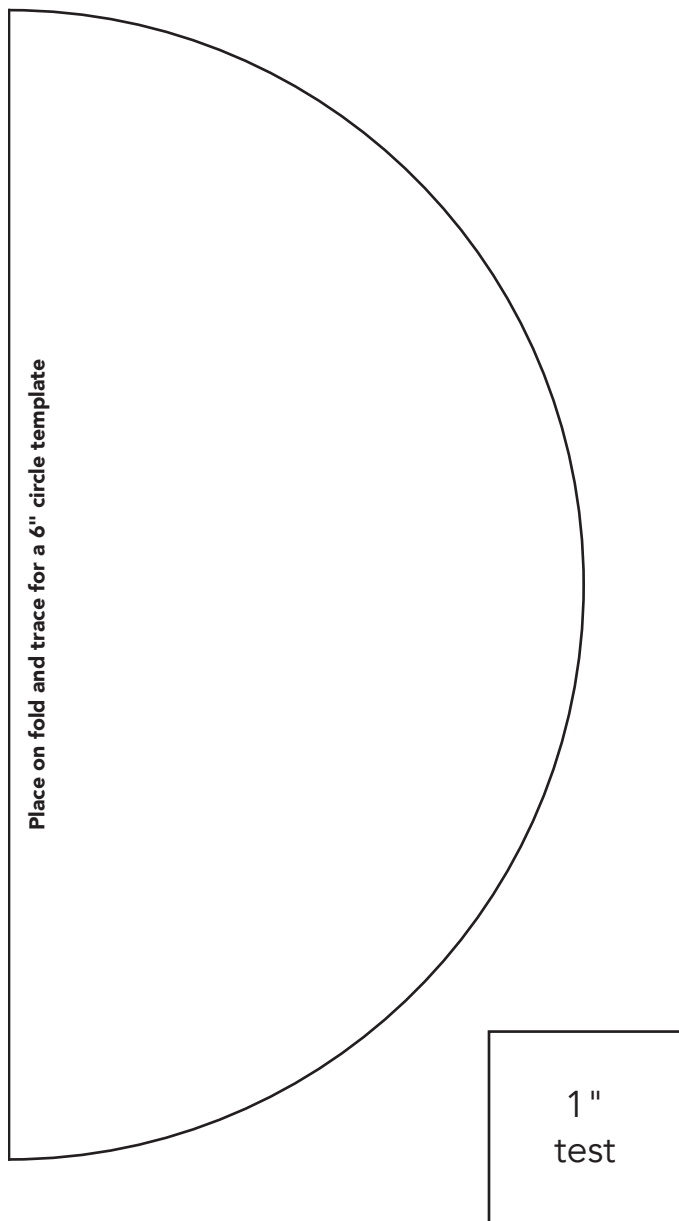

## Quilt Planning Diagram

Use this template to plan your quilt

