

Heather Under the Stars

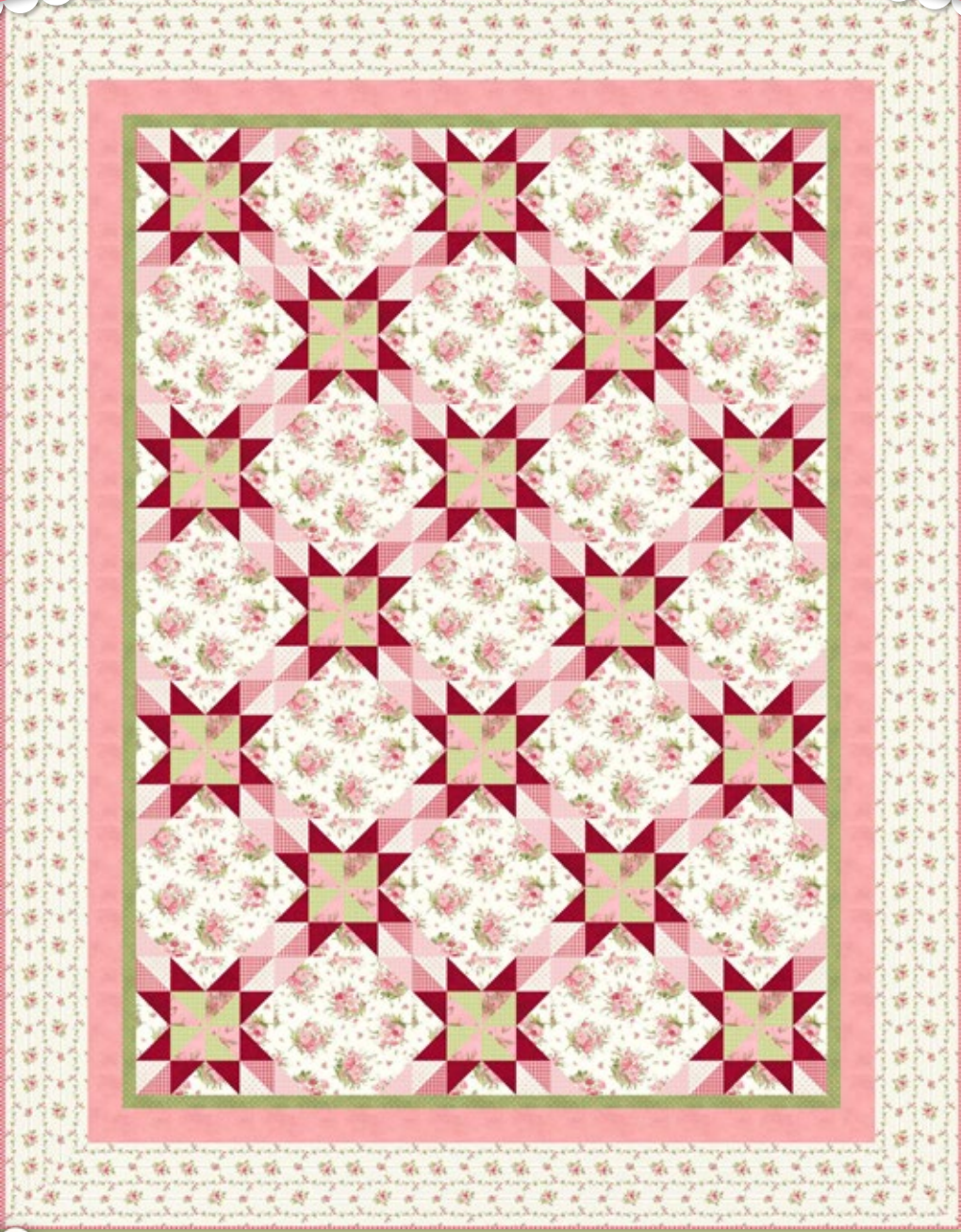

ShabbyFabrics.com

Heather Under the Stars

Designed by Jennifer Bosworth

69½" × 89½"

NOTES

Please read through all instructions before beginning.

All seams are ¼" WOF = Width of Fabric

CUT THE FABRIC

From **Fabric A**, cut:

- (17) 10½" × 10½" squares
- (72) 3⅜" × 3⅜" squares

From **Fabric B**, cut:

- (68) 3" × 3" squares

From **Fabric C**, cut:

- (36) 3⅜" × 3⅜" squares

From **Fabric D**, cut:

- (36) 3⅜" × 3⅜" squares

From **Fabric E**, cut:

- (36) 3⅜" × 3⅜" squares

From **Fabric F**, cut:

- (36) 3⅜" × 3⅜" squares
- Enough 2½" strips *on the bias* so that, when pieced, **binding** measures at least 326"

From **Fabric G**, cut:

- (72) 3⅜" × 3⅜" squares

From **First Inner Border** fabric, cut:

- (9) 1½" × WOF strips

From **Second Inner Border** fabric, cut:

- (9) 3" × WOF strips

From **Outer Border** fabric, cut:

- (2) 77½" × 6½" *down length of fabric* for **top and bottom outer borders**
- (2) 97½" × 6½" *down length of fabric* for **side outer borders**

IMPORTANT: When cutting outer borders, use stripes as reference so all four borders are the same. This will result in matched stripes at the corners of the border.

HOW TO MAKE HALF-SQUARE TRIANGLE UNITS

Step 1: Place two 3⅜" × 3⅜" squares RST with the lighter fabric on the top. Draw a line from one corner diagonally to the other corner. **Step 2:** Sew ¼" on either side of the drawn line. **Step 3:** Cut on the drawn line. **Step 4:** Open and press seam towards dark fabric. You will now have two pieces.

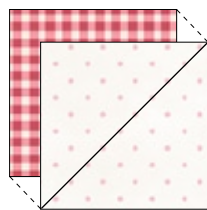

Step 1

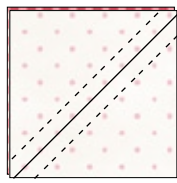

Step 2

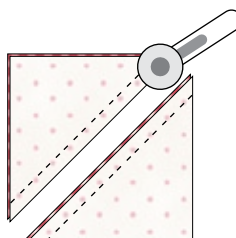

Step 3

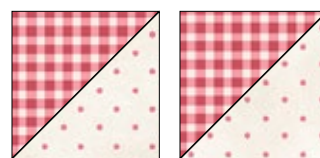

Step 4

ASSEMBLE STAR BLOCKS

All $3\frac{3}{8}$ " squares will be used for your half-square triangles. Create half-square triangle units as follows:

- Sew (72) Fabric A squares and (72) Fabric G squares to yield (144) A/G units.
- Sew (36) Fabric C squares and (36) Fabric D squares to yield (72) C/D units.
- Sew (36) Fabric E squares and (36) Fabric F squares to yield (72) E/F units.

Using the diagram (*upper right*) for reference, sew the half-square triangle units together in rows. Then sew the rows together into a block, pressing all seams open.

Continue for a total of 18 Star Blocks.

Each completed block should measure $10\frac{1}{2}$ " \times $10\frac{1}{2}$ ".

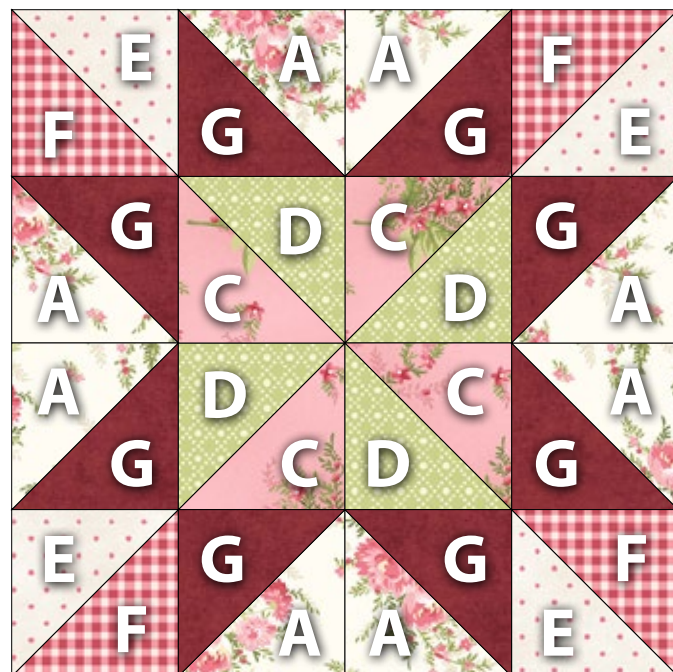

ASSEMBLE SNOWBALL BLOCKS

On the wrong side of each 3" Fabric B square, draw a diagonal line from one corner to the other.

Place a 3" Fabric B square in one corner of a $10\frac{1}{2}$ " \times $10\frac{1}{2}$ " Fabric A square (*as shown at right*), right sides together. Sew ON the drawn line. Repeat for all corners of the Snowball block. Trim excess fabric to a $\frac{1}{4}$ " seam. Fold corner triangles back and press seams toward corners.

Continue for a total of 17 Snowball Blocks.

Each completed block should measure $10\frac{1}{2}$ " \times $10\frac{1}{2}$ ".

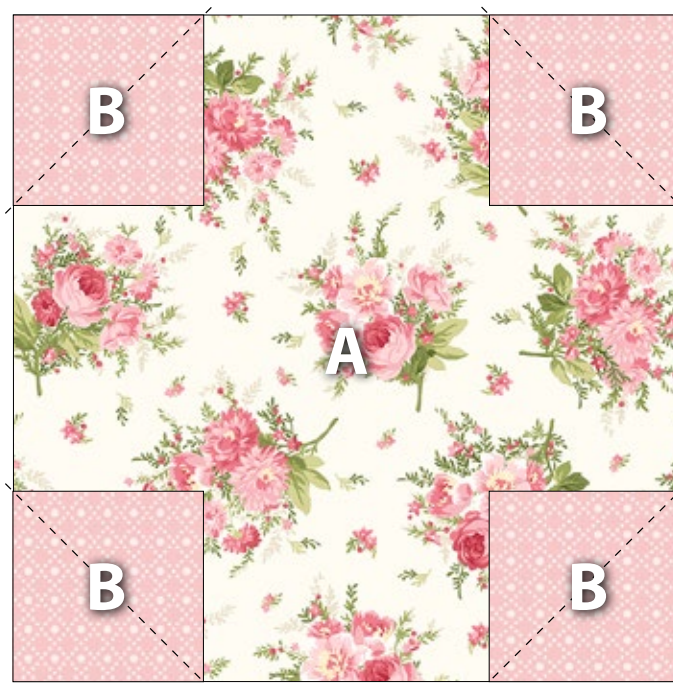

ASSEMBLE THE QUILT

Referring to cover image, arrange blocks as shown.

Sew the blocks together, one row at a time, pressing seams toward Snowball blocks. Then sew Row 1 to Row 2. Sew Row 3 to Row 4. Sew Row 5 to Row 6.

Sew Row 1/2 to Row 3/4. Sew Row 5/6 to Row 7. Finally, sew Row 1/2/3/4 to Row 5/6/7.

ADD MITERED BORDERS

Sew **first inner border** strips into one continuous strip. Cut into (2) 77½" strips and (2) 97½" strips.

Sew **second inner border** strips into one continuous strip. Cut into (2) 77½" strips and (2) 97½" strips.

Referring to **Diagram 1** (*below*), join similarly sized **first inner borders**, **second inner borders** and **outer borders**.



Diagram 1

Find the middle of one **top/bottom border** strip (77½") by folding it in half and gently finger-pressing the center. Align the center of the border strip with the center of the top or bottom of the quilt. With RST, pin the border strip in place along the edge of the quilt, working from the middle towards the outer corners. The border strip will be longer than the quilt – do not trim.

At the corners of the quilt, measure in ¼" from each end along the border and mark with a pin. This will indicate your starting and stopping points for sewing. Sew one border strip to the quilt, making sure to start and stop your sewing at the pins you marked (**Diagram 2**). Press the seam toward the border.

Repeat this process for all four sides of the quilt, using 97½" strips for **side borders**. When you reach a border that has already been sewn and pressed, your stopping point should not overlap your previous seam (**Diagram 3**). When all seams have been pressed toward the border, you will have four overlapping corners (**Diagram 4**).

To miter the quilt corners, fold the quilt diagonally, RST, aligning raw edges of adjacent borders. Align a ruler along the diagonal fold and mark a line from the outer border seam to the raw edge (**Diagram 5**).

Pin along the marked line. Open and check that your stripes all meet. If they don't, adjust and repin until they do. When they do, sew on the line from the outer border seam to the raw edge. Unfold the quilt (**Diagram 6**). Trim the seam allowance to ¼" and press the seam open.

Miter the three remaining corners of the quilt in the same manner.

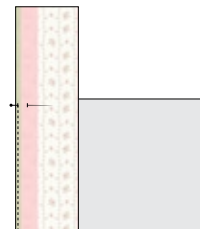

Diagram 2

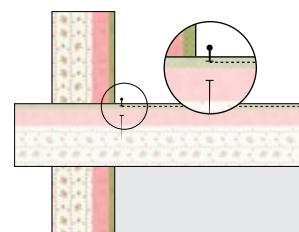

Diagram 3

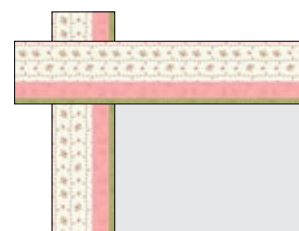

Diagram 4

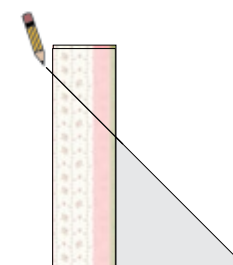

Diagram 5

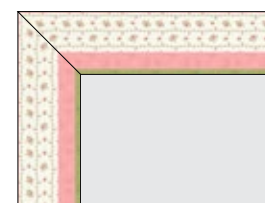

Diagram 6

FINISH THE QUILT

Layer quilt top, batting, and backing. Quilt as desired.

Fold pieced binding in half lengthwise with wrong sides together and press. Sew the binding to the front side of the quilt, starting at any side. Turn the binding over and hand stitch to the back of the quilt.

Visit ShabbyFabrics.com for your next sewing project!

Heather Under the Stars

69½" × 89½"

REQUIRED MATERIALS



Fabric A
MAS8392-E
2⅞ yards



Fabric B
MAS8397-P
⅝ yard



Fabric C
MAS8393-P
½ yard



Fabric D
MAS8397-G
½ yard



Fabric E
MAS609-EP
½ yard

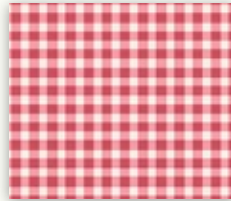

Fabric F
MAS610-P6
1¼ yard
(includes binding)



Fabric G
MAS513-PXR
¾ yard



**First
Inner Border**
MAS609-GS2
½ yard



**Second
Inner Border**
MAS513-P8
⅞ yard



Outer Border
MAS8395-E
2¾ yard

Backing
5½ yards

ShabbyFabrics.com